

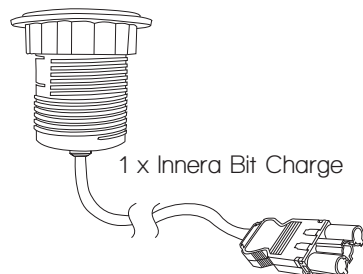

⚠ ATTENTION: Read the instructions prior to installation.

Components:



Tools required:

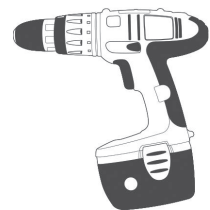

Critical safety information:

- Prior of use, please examine and verify that the product is not defected. Please do not install or operate if there is a defect of any kind.
- If in any case you are facing misunderstanding of installation procedure, the installation should be carried out by certified electrician
- Make sure you are installing the product on smooth straight surface. Do not install in any case that the surface is not straight or if there are levels differences.
- Make sure water will not penetrate into the unit. In any case please make sure you are installing the unit, where proper leakage protection device is connected.

Installation:

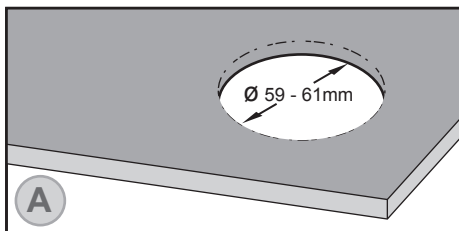

Drill hole into the surface in cut out of 59 - 61mm. Please keep 2.5cm between the edge of the surface to the hole. Make sure that there is enough space beneath the surface for the Bit Charge.

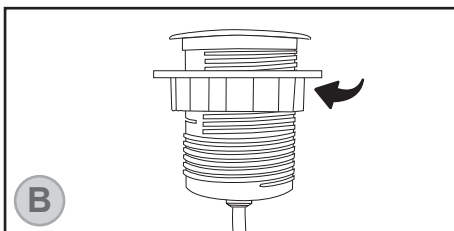

Remove the locking ring by rotating it opposite to clockwise direction before you are entering the Innera Bit Charge into the hole.

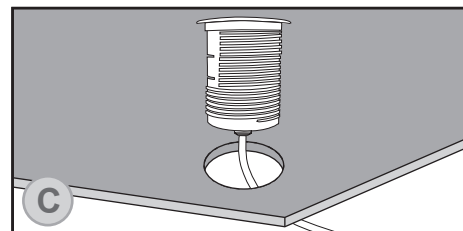

Insert the Innera Bit Charge into the hole.

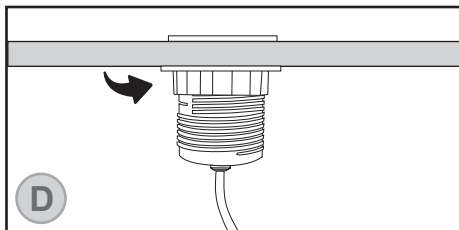

Tight the locking ring by turn it clockwise until it is tightly strongly to the surface and verify the Innera Bit Charge is firmed and cannot be rotated.

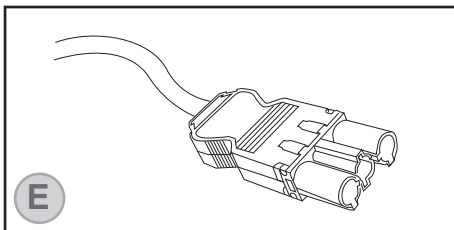

Connect the GST Male connector to power and the Innera Bit Charge is ready for use.

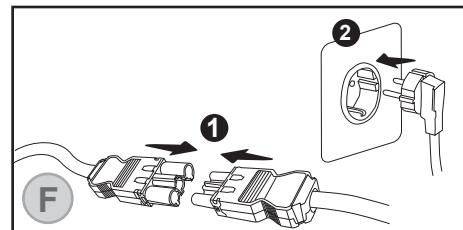

REMARK: In case you need to connect the Innera Bit Charge to a standard socket, you should buy a **starter cable** separately which not included in this Kit and connect it according to illustration above.

Operation:

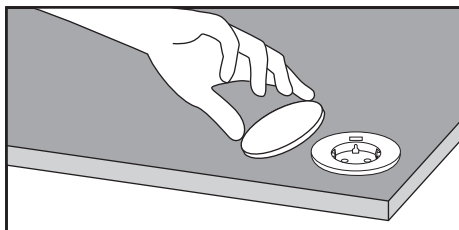

While not using the Innera Bit Charge, it is better to cover it with the Innera Bit CAP, for better maintenance of the item. The Innera Bit CAP is not included as part of this Kit, and you should buy it separately.

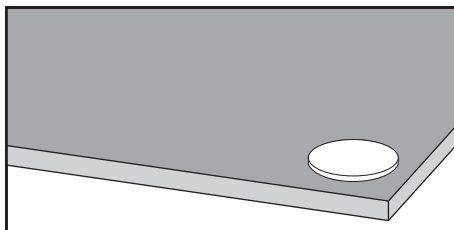

The Innera Bit Charge is covered.

Cleaning:

The product can be cleaned by a soft and dry fabric. Please do not use moisture, abrasives materials, solvents or any detergents which can be conductive